

THE FOYER GALLERY PROGRAM

LOCATED WITHIN THE GOSFORD REGIONAL GALLERY, THE FOYER GALLERY IS AN EXHIBITION SPACE FOR EARLY CAREER AND ESTABLISHED CONTEMPORARY ARTISTS. THE FOYER GALLERY PROGRAM IS A SUPPORTED OPPORTUNITY WHERE ARTISTS ARE PAID \$2000 TO EXPLORE AND DISPLAY A NEW OR EXISTING BODY OF WORK, GUIDED BY THE GALLERY CURATOR. EXHIBITIONS GENERALLY RUN FOR FOUR TO FIVE WEEKS AND ARE PROGRAMMED IN LINE WITH THE MAIN GALLERY SPACE.

Gosford Regional Gallery





GOSFORD REGIONAL GALLERY BACKGROUND

Gosford Regional Gallery is located on the shores of Caroline Bay in East Gosford. It is part of a complex that also includes the Edogawa Commemorative Garden, the Arts Centre, Gallery Shop and the Top Point Café.

The Gallery was officially opened in April 2000 and is visited by approximately 170,000 people each year. The Gallery hosts a diverse range of local, national and international exhibitions of various media. The Gallery is an important cultural, tourism and educational resource for the Central Coast community.

VISION

Celebrating Creativity,
Engaging Community,
Promoting Culture.

MISSION

To provide an engaging, accessible space which celebrates arts and culture, through dynamic and diverse exhibitions and educational opportunities, contributing to the development of a culturally rich community.

SUBMISSION ASSESSMENT CRITERIA

A panel of Gosford Regional Gallery staff reviews Foyer Gallery proposals twice a year to consider the following aspects of each proposal:

Technique: The level of technical skill demonstrated by the artist

Concept: Is the exhibition coherently united by an interesting / innovative concept?

Diversity: Does the exhibition contribute to the diversity of our exhibition program?

Interest: Will the exhibition appeal to a range of visitors / will it bring new visitors to the Gallery?

Presentation: Will the artworks be presented in a professional manner?

APPLICATION DEADLINES

Assessment	Deadline for Submissions	Exhibition Period
April	1 April	2025 onwards
November	1 November	2025 onwards

HOW TO APPLY

Complete the fillable submission form and email by application deadline to:

Jasmine.Kean@centralcoast.nsw.gov.au

YOUR SUBMISSION MUST INCLUDE:

Explanation of the theme or premise of the exhibition.

Why is this exhibition relevant to the Gosford Regional Gallery program? (see general information about Gosford Regional Gallery)

List of works, including: Artist, title, date, medium, dimensions for each work. If a complete list of works is not known, please provide a description of the anticipated number, medium and size of works.

Description of any special requirements including equipment, handling requirements, installation materials and costs.

CV and artist's statement for each artist and curator involved in the exhibition

Images of the artist(s) work and an image list.

Instagram handle and/or website

FOYER GALLERY FLOOR PLAN

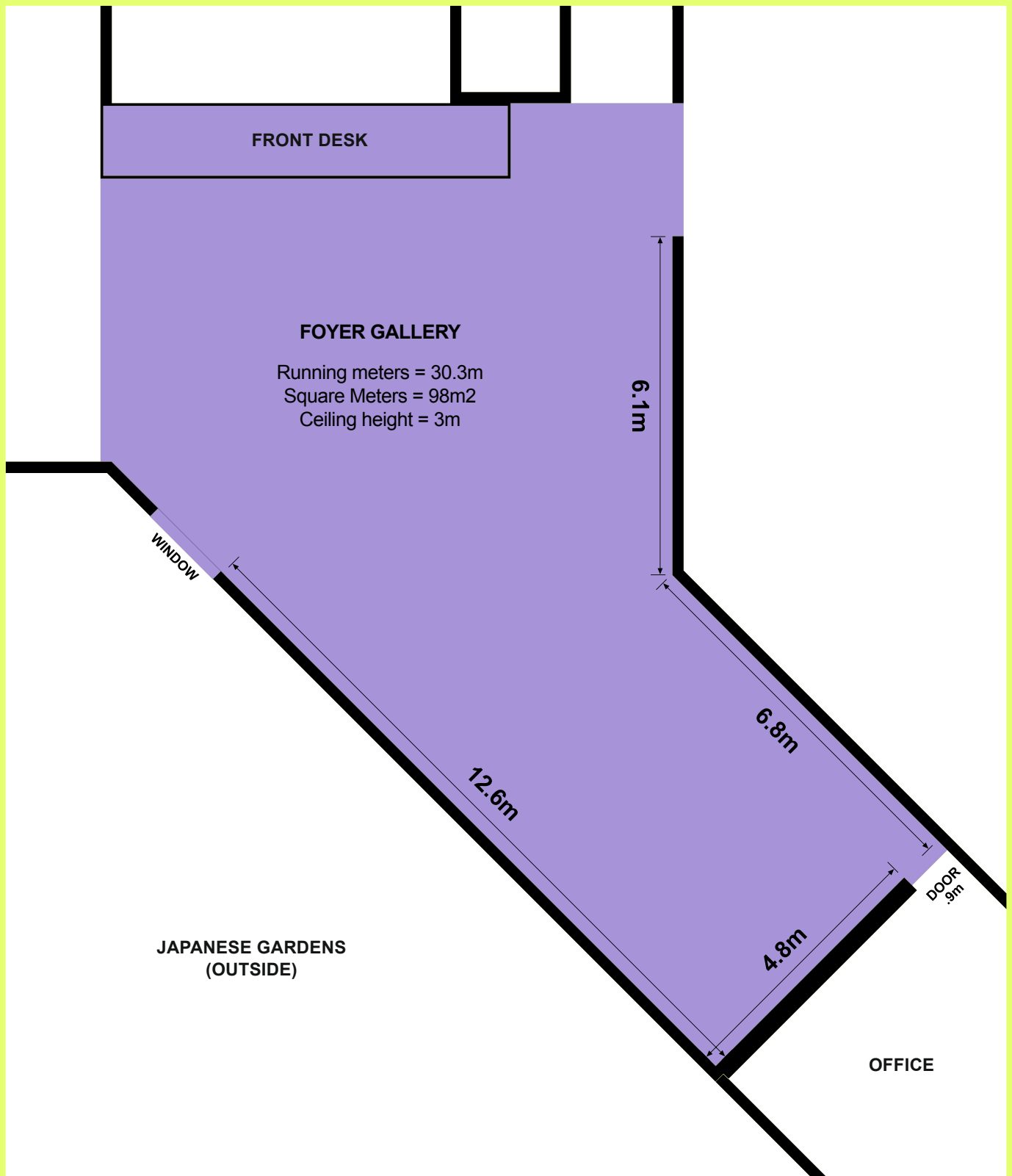

SUBMISSION FORM

Artist name:

Email:

Address:

Date of birth:

Postcode:

Instagram:

Contact phone:

Website:

Title of proposed exhibition:

All exhibiting artists' names:

Availability:

Please list above the date range that the artworks will be available for the exhibition. Please note, exhibitions in the Foyer Gallery generally run for 4 to 5 weeks and are programmed by Gallery staff up to 3 years in advance. Your preferred dates may not be available, so please list a range of alternative dates.

Concept: (up to 500 words)

SUBMISSION FORM

Physical description: (up to 250 words)

I have attached my CV and images

Applicant Signature:

Name:

Date:

Please email your application to Curator, Jasmine Kean
Jasmine.Kean@centralcoast.nsw.gov.au



Gosford Regional Gallery

36 Webb Street, East Gosford,
New South Wales, 2250

02 4304 7550

gallery@centralcoast.nsw.gov.au
www.gosfordregionalgallery.com

Open daily 9:30am – 4:00pm

*The gallery is open all year round with the exception of
Christmas Day, Boxing Day, New Year's Day and Good
Friday*

Central
Coast
Council